

HARKEN®

USA – Tel: (+1) 262-691-3320 • Web: www.harken.com • Email: harken@harken.com
Italy – Tel: (+39) 031.3523511 • Web: www.harken.it • Email: techservice@harken.it

INSTALLATION SHEET

Midrange Control Blocks, Track and Trim Caps

Control Blocks: 1631, 1632, 1633; Track: R27, 1602, R27HB; Trim Caps: 1621, 1622



WARNING! Strictly follow all instructions to avoid an accident, damage to your vessel, personal injury, or death. See www.harken.com/manuals for additional safety information.

Read Instructions Before You Cut or Mount Track

It might be necessary to put trim caps, control blocks, and traveler car on track before mounting. Slide control assemblies onto track with bumper facing car. Keep control assembly loose so it can be moved out of the way while installing track.

Cut Track

To cut track to length, make sure stop holes for control blocks do not interfere with hole for mounting track. If necessary, cut both ends of track.

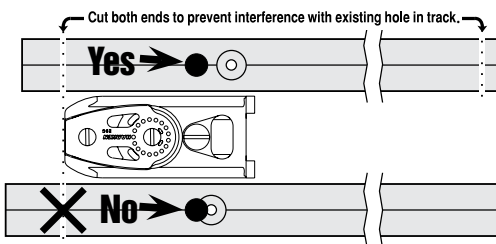

Cockpit Installation

To determine correct track length, make sure track ends, without trim caps, are 19 mm ($\frac{3}{4}$ ") from edge of cockpit coaming.

Mount Track

Through-bolt track per instructions provided with track.

Install Control Blocks

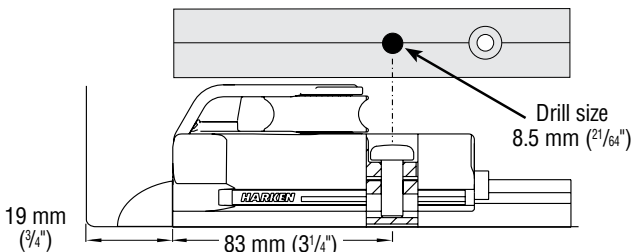

Position control block flush with end of track. Drive screw firmly against top surface to mark track, then loosen. Slide control block away.

IMPORTANT: Drill $\frac{21}{64}$ " (8.5 mm) hole only through top surface of track. Do not use screw hole in control block as drill guide.



1602, 1616, 1617
Use 20 mm screws.



1618
Use 35 mm screws.

Secure control block to track by tightening correct screw into hole.

Deadending Line at End Control



IMPORTANT: Insert loop down from above.

Install Trim Caps

Remove any burrs on edges of track. Press 1621 or 1622 trim caps in place.

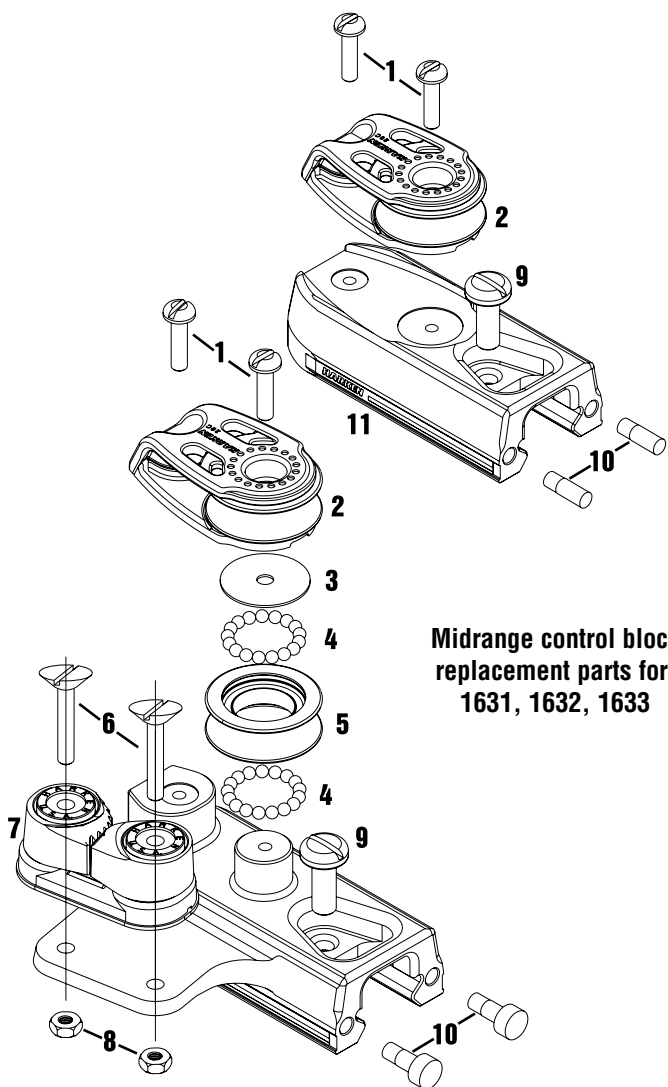

**Midrange control block
replacement parts for:
1631, 1632, 1633**

Control Block Replacement Parts

1	HFS1019	Cheek assembly screws (2)	8	HFS576	Cam assembly nut (2)
2	2644	Cheek block	9	HMR64	Control block screw (set)
3	H-34333A	Washer		HFS1023	m8x1.25x20 mm
4	MP-119	Bearings (38)		HFS1024	m8x1.25x30 mm
5	H-25863B	Sheave	10	MP-1951	Control block bumpers (2)
6	HFS1078	Cam assembly screws (2)	11	4300	Harken label
7	365	Carbo cam cleat			

Inspect

Frequently inspect retaining screw and control block fittings for signs of loosening. Replace as necessary. Make sure every installation includes Harken track endstops. Arrange control tackle so cars do not hit endstops under load.

Maintenance

Traveler cars: Clean by frequently flushing with fresh water. Periodically clean car by squirting a detergent/water solution into center openings. Roll car back and forth to distribute evenly. Flush bearings with fresh water.

Do not use spray lubricants because ball bearings can skid, not roll. Once car and track are dry, apply one (1) to two (2) drops of McLube® OneDrop™ ball bearing conditioner to ball contact surfaces of track. Roll car back and forth through OneDrop conditioner several times to distribute onto bearings. Wipe remaining OneDrop off track. OneDrop conditioner is preferred, but you can also use one (1) to two (2) drops of a light machine oil. Too much oil attracts dirt.

Track: Clean with detergent and water.

Important! Exposure to some teak cleaners and other caustic solutions can result in discoloration of part and is not covered under the Harken warranty.

McLube is a registered trademark of McGee Industries, Inc.
OneDrop is a trademark of McLube, a division of McGee Industries, Inc.

Warranty

For additional safety, maintenance and warranty information see www.harken.com/manuals or the Harken catalog.